



### Dodge Dakota 1987-1996

Visit [MetraOnline.com](http://MetraOnline.com) for more detailed information about the product and up-to-date vehicle specific applications

#### KIT FEATURES

- ISO DDIN radio provision
- Multiple textures to blend original finishes with modern radio looks.
- Full dash panel replacement to accommodate for most after market DDIN radios

#### KIT COMPONENTS

- A) Dash panel • B) Radio brackets • C) Climate control relocation template • D) Pal nuts (4) • E) #8 x 1/2" Phillips screw (1)

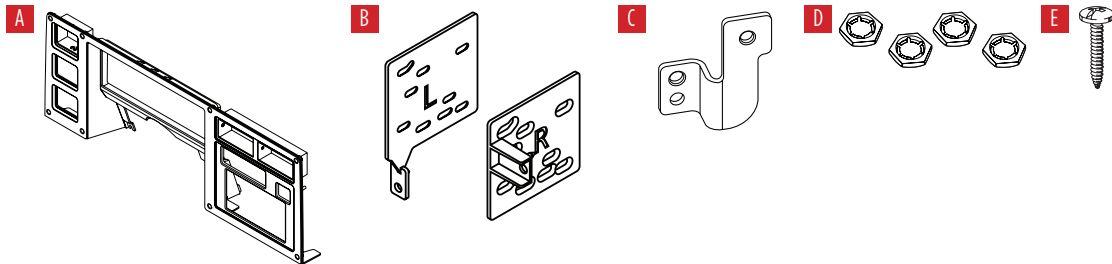

#### TABLE OF CONTENTS

Dash Disassembly .....	2-3
Kit Preparation.....	4-5
Kit Assembly .....	5

#### WIRING & ANTENNA CONNECTIONS (sold separately)

Wiring Harness: Visit [metraonline.com](http://metraonline.com) for audio/video and steering wheel control interface options.  
Antenna Adapter: Not required.

#### TOOLS REQUIRED

- Panel removal tool • Phillips screwdriver
- Socket wrench

**Attention!** With the key out of the ignition, disconnect the negative battery terminal before installing this product. Ensure that all installation connections are secure before cycling the ignition to test this product.

## DASH DISASSEMBLY

1. Remove (8) T-20 Torx screws securing the entire dash panel to the sub dash. (Figure A)
2. Remove (2) Phillips screws from the knee bolster panel below the steering column then unclip and remove the panel. (Figure B)

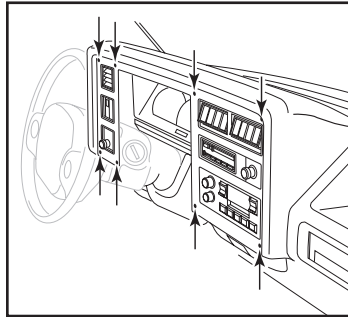

(Figure A)

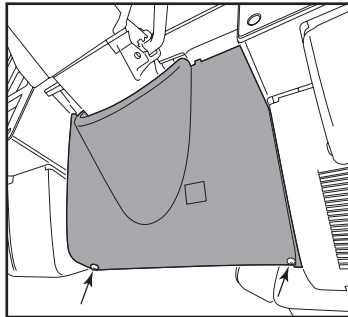

(Figure B)

3. Remove (1) Phillips screw from each side of the steering column from the factory dash panel. (Figure C)
4. Unclip and remove the entire factory dash panel from the sub dash. (Figure D)
5. Remove (2) Phillips screws securing the factory radio chassis.
6. Remove (2) Phillips screws securing the climate control and leave loose in dash to allow room for trimming the sub dash.

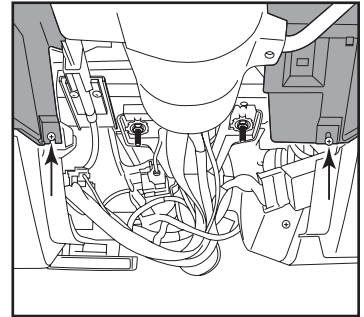

(Figure C)

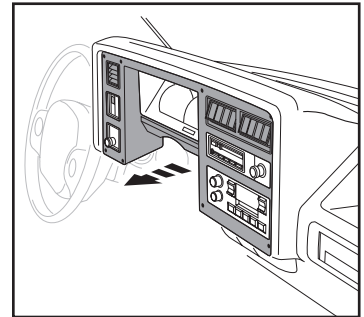

(Figure D)

*Continued on the next page*

## DASH DISASSEMBLY (CONT.)

7. Remove (2) Phillips screws securing the cigarette lighter.
8. Trim the area indicated from the cigarette lighter. (Figure E)
9. Unclip and remove the A/C vents from the factory radio panel and keep for Kit Assembly. (Figure F)
10. Carefully cut the tabs holding the rubber steering column trim to the factory panel and keep for Kit Assembly.  
**Note:** Be careful not to damage the rubber steering column trim. (Figure F)

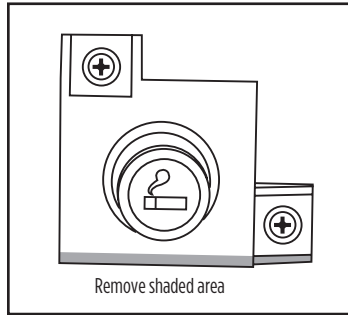

(Figure E)

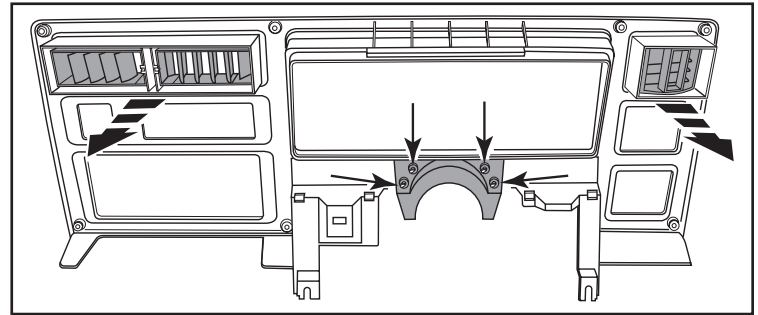

(Figure F)

*Continue to Kit Preparation*

## KIT PREPARATION

1. Snap the A/C vents in to the **DP-6508 panel**. (Figure A)
2. Attach the rubber steering column trim to the **DP-6508 panel** using the supplied (4) pal nuts. **Tip:** You can use a 11/32" socket to thread the Pal Nuts onto the posts on the DP-6508. (Figure B)

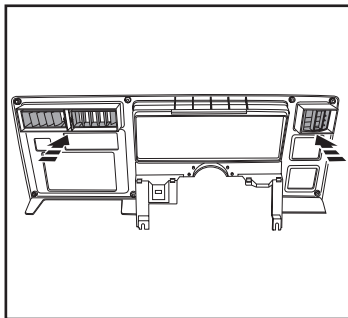

(Figure A)

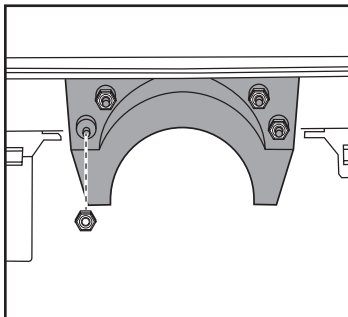

(Figure B)

3. Cut and trim the sub dash in the shaded areas. **Note:** Cuts should be carefully done as the dash will be very fragile. (Figure C)
4. Using the provided **template** make the new hole for the right side of the climate control by attaching the **template** to the left mounting hole for the cigarette lighter. Drill small pilot hole above existing mounting hole in dash. (Figure D)

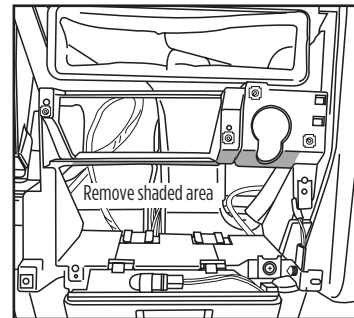

(Figure C)

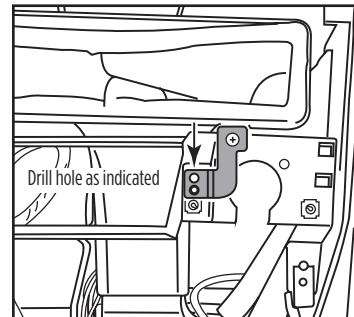

(Figure D)

## KIT PREPARATION *(CONT.)*

1. Secure the climate control in the new location using the locator hole on the climate control on the left side (bottom hole) instead of the mounting hole and then the new hole drilled in the previous step for the right side. (Figure E)

*Continue to Kit Assembly*

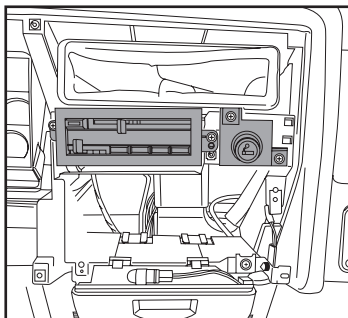

*(Figure E)*

## KIT ASSEMBLY

1. Attach the **radio brackets** to the aftermarket radio using screws supplied with the radio. (Figure A)
2. Locate the factory wiring harness and antenna connector in the dash, and complete all necessary connections to the radio. Metra recommends using the proper mating adapter from Metra and/or AXCESS. Re-connect the negative battery terminal and test the radio for proper operation.
3. Snap the **DP-6508 dash panel** over the radio and secure with the factory hardware.
4. Reassemble the dash in reverse order of disassembly.

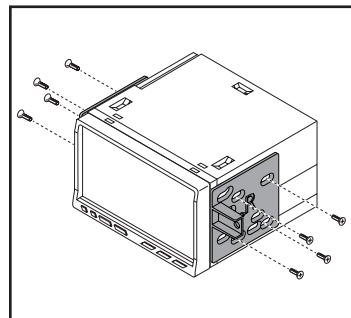

*(Figure A)*







# DP-6508

INSTALLATION INSTRUCTIONS



Having difficulties? We're here to help.



Contact our Tech Support line at:

**386-257-1187**



Or via email at:

[techsupport@metra-autosound.com](mailto:techsupport@metra-autosound.com)

### Tech Support Hours (Eastern Standard Time)

Monday - Friday: 9:00 AM - 7:00 PM

Saturday: 10:00 AM - 5:00 PM

Sunday: 10:00 AM - 4:00 PM



**Metra recommends MECP  
certified technicians**