



## Chevrolet Astro/GMC Safari 1995-2005

Visit [MetraOnline.com](http://MetraOnline.com) for more detailed information about the product and up-to-date vehicle specific applications

### KIT FEATURES

- ISO DDIN radio provision

### KIT COMPONENTS

- A) Radio trim panel • B) Radio brackets • C) Cutting template

A

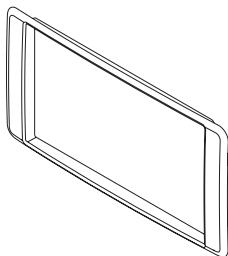

B

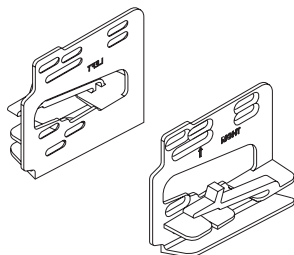

C

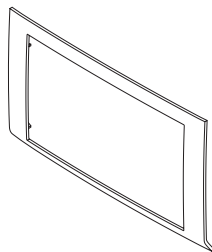

### TABLE OF CONTENTS

Dash Disassembly .....	2
Kit Preparation .....	2
Kit Assembly .....	3

### WIRING & ANTENNA CONNECTIONS (sold separately)

Wiring Harness: 70-1858

Antenna Adapter: 40-GM10

Pocket: 88-00-3302

### TOOLS REQUIRED

- Panel removal tool • Phillips screwdriver
- Cutting tool • Scribe tool

**Attention!** Let the vehicle sit with the key out of the ignition for a few minutes before removing the factory radio. When testing the aftermarket equipment, ensure that all factory equipment is connected before cycling the key to ignition.

## DASH DISASSEMBLY

1. Engage the parking brake, then place the gear selector in the lowest position.
2. Unclip, unplug, and remove the dashboard trim panel. (Figure A)
3. Depress the tabs securing the radio and slide the radio out in one motion. Unplug and remove the radio.

*Continue to Kit Preparation*

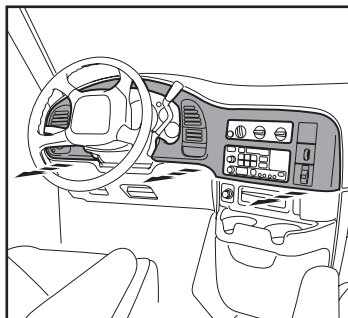

(Figure A)

## KIT PREPARATION

1. Place the **cut template** over the dashboard trim panel. (Figure A)
2. Using a scribe tool, score the area in the radio section to be cut. (Figure B)
3. Remove the **cut template**, then cut the scored area with a cutting tool.
4. Clip the **radio trim panel** onto the dashboard trim panel. (Figure C)

*Continue to Kit Assembly*

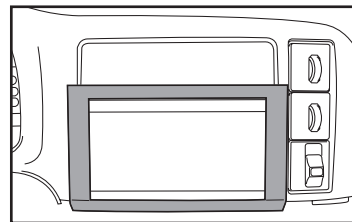

(Figure A)

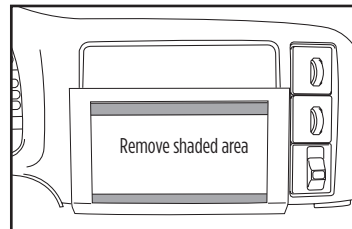

(Figure B)

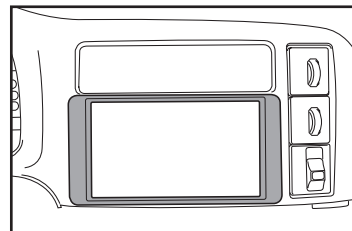

(Figure C)

## KIT ASSEMBLY

1. Secure the **radio brackets** to the radio using the screws supplied with the radio. (Figure A)
2. Locate the factory wiring harness and antenna connector in the dash and complete all necessary connections to the radio. Metra recommends using the proper mating adapter from Metra and/or Axxess. Test the radio for proper operation.
3. Clip the radio assembly into the dash.
4. Reassemble the dash in reverse order of disassembly to complete the installation.

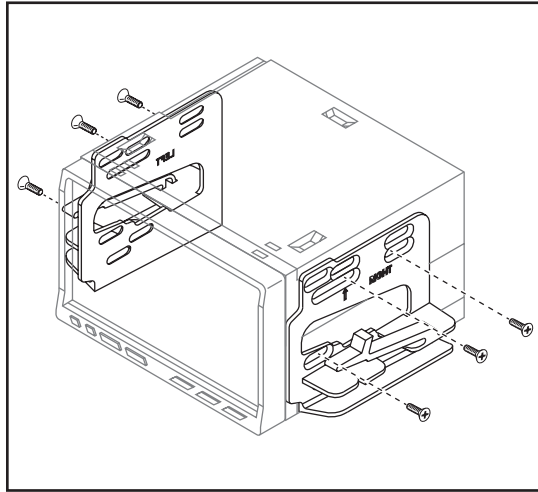

(Figure A)



**95-3005**  
INSTALLATION INSTRUCTIONS



If you are having difficulties with the installation of this product, contact our Tech Support line either by phone at **1-800-253-TECH**, or email at **techsupport@metra-autosound.com**. Before doing so, look over the instruction booklet a second time and ensure that the installation was performed exactly as the instruction booklet is stated. Have the vehicle apart and ready to perform troubleshooting steps before contacting Metra/Axxess Tech Support.



**KNOWLEDGE IS POWER**

Enhance your installation and fabrication skills by enrolling in the most recognized and respected mobile electronics school in our industry. Log onto [www.installerinstitute.com](http://www.installerinstitute.com) or call 800-354-6782 for more information and take steps toward a better tomorrow.



**Metra recommends MECP  
certified technicians**