



INSTALLATION INSTRUCTIONS FOR PART 95-7863

APPLICATIONS

Honda Element 2003-2010 95-7863

KIT FEATURES

- Double DIN head radio provision
- Textured to match factory dash

KIT COMPONENTS

- A) Double DIN trim plate • B) Double DIN brackets • C) O.E. Replacement panel



A

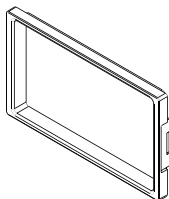

B

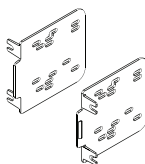

C



WIRING & ANTENNA CONNECTIONS (Sold Separately)

Wiring Harness:

- 70-1721 - Honda/Acura harness 1998-up
- 70-7863 - Element sub and AUX integration

Antenna Adapter:

- 40-hd10 - Honad/Acura antenna adapter
(for Element 2005-up)

TOOLS REQUIRED

- Panel removal tool • Phillips screwdriver

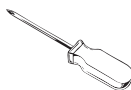
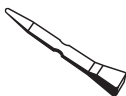

METRA. THE WORLD'S BEST KITS.™



1-800-221-0932



metraonline.com

© COPYRIGHT 2004-2011 METRA ELECTRONICS CORPORATION

REV. 12/28/11



95-7863

Table of Contents

Dash Disassembly

– Honda Element 2003-2010.....3

Kit Assembly

– Double DIN head radio provision4

CAUTION: *Metra recommends disconnecting the negative battery terminal before beginning any installation. All accessories, switches, and especially air bag indicator lights must be plugged in before reconnecting the battery or cycling the ignition.*

Note: *Refer also to the instructions included with the aftermarket radio.*



KNOWLEDGE IS POWER

Enhance your installation and fabrication skills by enrolling in the most recognized and respected mobile electronics school in our industry. Log onto www.installerinstitute.com or call 800-354-6782 for more information and take steps toward a better tomorrow.



Metra recommends MECP certified technicians

Honda Element 2003-2010

1. Disconnect the negative battery terminal to prevent an accidental short circuit.
2. Unsnap and remove shift lever trim panel. For manual transmission models, untwist shift knob. (Figure A)
3. Unsnap and remove center dash panel. (Figure B)
4. Remove (4) Phillips screws and remove radio. (Figure C)

Tip: As an option, the center panel (the smaller piece around radio) is all that needs to be removed. Note, it is prone to damage--full panel removal is recommended. (Figure C)

Continued to kit assembly

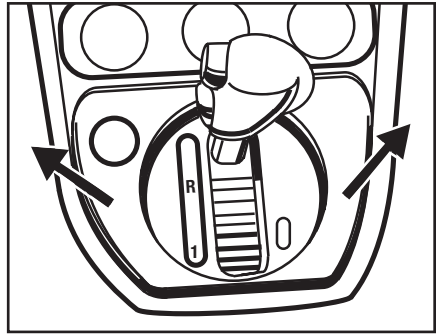

(Figure A)

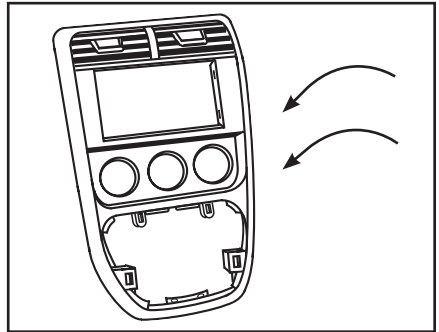

(Figure B)

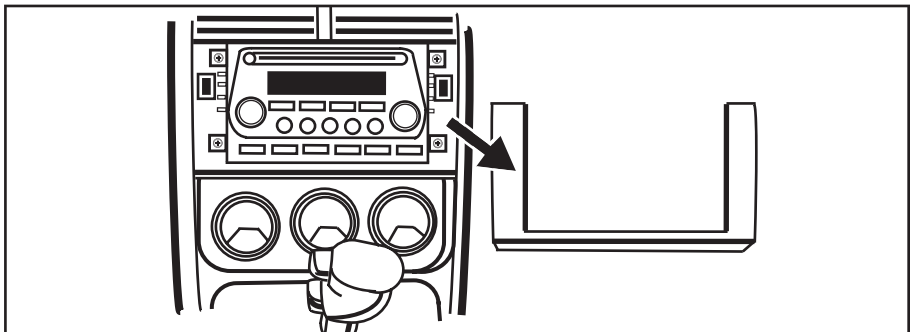

(Figure C)



Kit Assembly 95-7863

Double DIN head radio provision

1. Attach the Double DIN brackets to the Double DIN trim plate. (Figure A)
2. Slide the Double DIN head unit into the bracket/radio housing assembly and secure the Double DIN head unit to the assembly using the screws supplied with the radio. (Figure B)
3. Locate the factory wiring harness in the dash. Metra recommends using the proper mating adapter from Metra or AXXESS. Re-connect the negative battery terminal and test the unit for proper operation.

Note: Models equipped with factory DDIN radio will require supplied O.E. Replacement panel. (Figure C)

4. Reassemble dash in reverse order of disassembly.

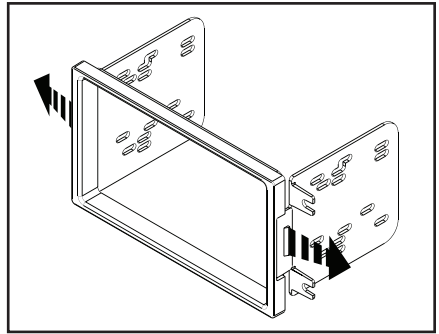

(Figure A)

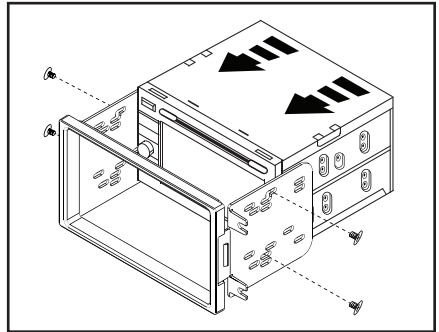

(Figure B)

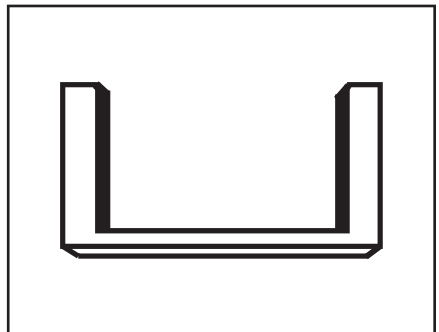

(Figure C)



INSTALLATION INSTRUCTIONS FOR PART 95-7863

REV. 12/28/11

METRA. THE WORLD'S BEST KITS.™



1-800-221-0932



metraonline.com

© COPYRIGHT 2004-2011 METRA ELECTRONICS CORPORATION



INSTRUCCIONES DE INSTALACIÓN PARA LA PIEZA 95-7863

Honda Element 2003-2010 95-7863

CARACTERÍSTICAS DEL KIT

- Provisión de unidad central doble DIN
- Texturizado para igualar el tablero de fábrica



COMPONENTES DEL KIT

- A) Placa de moldura DDIN • B) Soportes DDIN • C) O.E. Panel de reemplazo

A

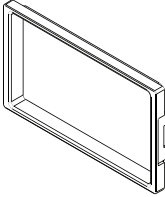

B

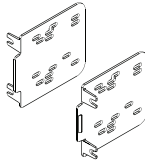

C



CABLEADO Y CONEXIONES DE ANTENA (se venden por separado)

Arnés de cableado:

- 70-1721 - Arnés para Honda/Acura 1998 y más recientes
- 70-7863 - Integración sub y AUX con Element

Adaptador de antena:

- 40-hd10 - Adaptador de antena para Honda/Acura (para Element 2005 y más recientes)

TOOLS REQUIRED

- Herramienta de remoción de panel • Destornillador Phillips

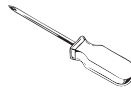

REV. 12/28/11

METRA. THE WORLD'S BEST KITS.™



1-800-221-0932



metraonline.com

© COPYRIGHT 2004-2011 METRA ELECTRONICS CORPORATION



95-7863

Indice

Desmontaje del tablero

– Honda Element 2003-2010.....3

Ensamble del kit

– Provisión de unidad central doble DIN.....4

PRECAUCIÓN: Metra recomienda desconectar el terminal negativo de la batería antes de comenzar cualquier instalación. Todos los accesorios, interruptores y, especialmente, las luces indicadoras de airbag deben estar enchufados antes de volver a conectar la batería o comenzar el ciclo de ignición.

Nota: Asimismo, remítase a las instrucciones incluidas con el radio de posventa.



KNOWLEDGE IS POWER

Enhance your installation and fabrication skills by enrolling in the most recognized and respected mobile electronics school in our industry. Log onto www.installerinstitute.com or call 800-354-6782 for more information and take steps toward a better tomorrow.



**Metra recommends MECP
certified technicians**

Honda Element 2003-2010

1. Desconecte el terminal negativo de la batería para evitar un cortocircuito accidental.
2. Suelte y retire el panel de moldura de la palanca de velocidades. Para modelos de transmisión manual, desatornille la perilla de la palanca de velocidades. (Figura A)
3. Suelte y retire el panel del tablero central. (Figura B)
4. Retire los (4) tornillos Phillips y retire el radio.

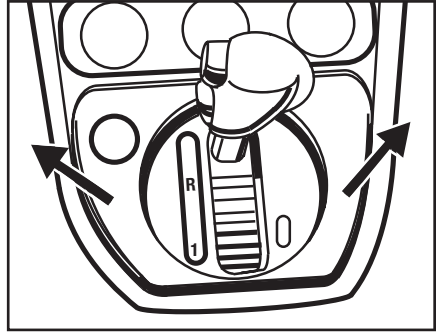

(Figura A)

Sugerencia: Como opción, solo el panel central (la pequeña pieza que rodea el radio) necesita retirarse. Nota: podría dañarse, por lo que se recomienda retirar todo el panel. (Figura C)

Continued to ensamble del kit

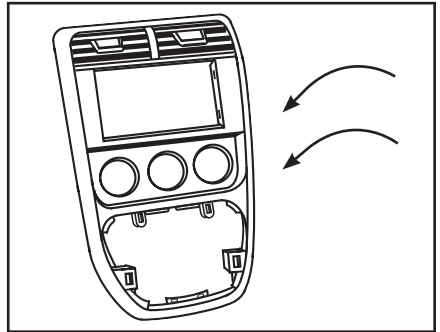

(Figura B)

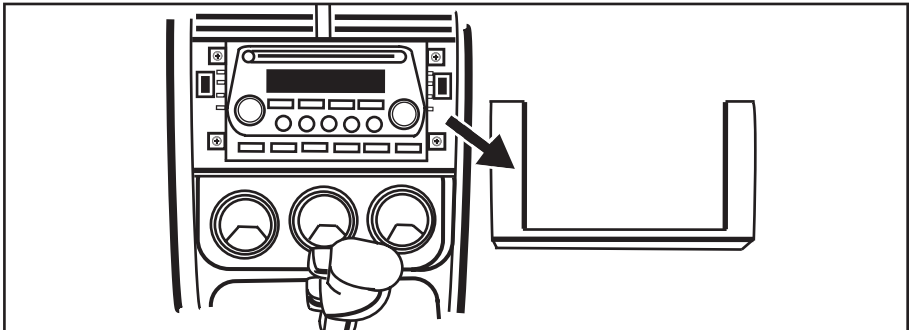

(Figura C)

Provisión de unidad central doble DIN

1. Coloque los soportes doble DIN en la placa de la moldura doble DIN. (Figura A)
2. Deslice la unidad central doble DIN en el ensamble del soporte/carcasa del radio y sujete la unidad central Doble DIN en el ensamble utilizando los tornillos suministrados con el radio. (Figura B)
3. Ubique el arnés del cableado de fábrica en el tablero. Metra recomienda usar el adaptador de acoplamiento adecuado de Metra o AXCESS. Vuelva a conectar el terminal negativo de la batería y pruebe la unidad para verificar que funcione correctamente.

Nota: Los modelos equipados con el radio DDIN de fábrica requerirán el panel de reemplazo de equipo original suministrado. (Figura C)

4. Vuelva a montar el tablero en forma inversa al desmontaje.

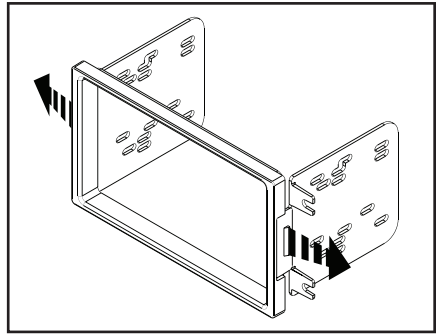

(Figura A)

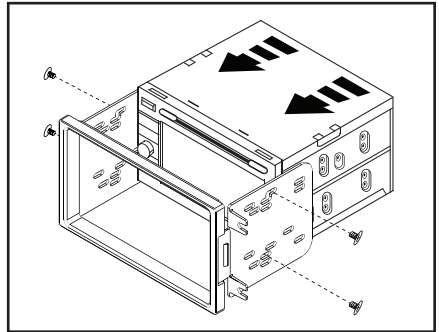

(Figura B)

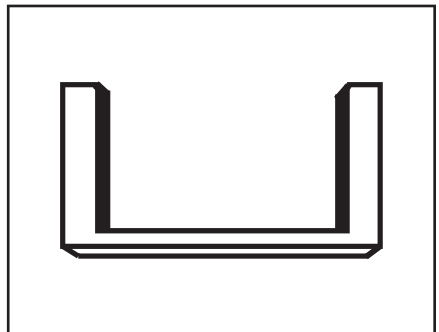

(Figura C)



INSTRUCCIONES DE INSTALACIÓN PARA LA PIEZA 95-7863

REV. 12/28/11

METRA. THE WORLD'S BEST KITS.™



1-800-221-0932



metraonline.com

© COPYRIGHT 2004-2011 METRA ELECTRONICS CORPORATION