



BMW 5-Series 2004-2007

Visit MetraOnline.com for more detailed information about the product and up-to-date vehicle specific applications

KIT FEATURES

- ISO DDIN radio provision
- ISO DIN radio provision with pocket (sold separately)
- Harnessing included to re-locate the factory radio chassis and retain the factory display
- Included interface retains steering wheel controls and provides necessary radio connections
- Painted matte black to match the factory finish

KIT COMPONENTS

- A) Radio trim panel • B) Climate control trim panel • C) Radio brackets • D) Panel clips (4) • E) #8 x 3/8" Phillips screws (2)
- F) Radio relocation harness (not shown) • G) Radio interface and harnessing (not shown)

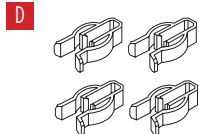
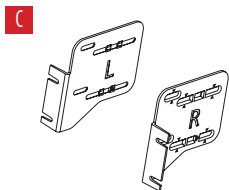
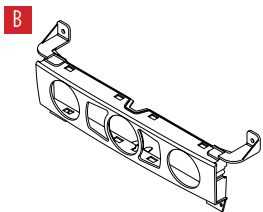
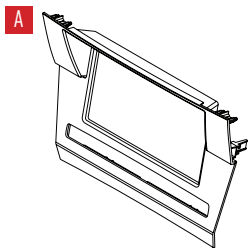

TABLE OF CONTENTS

Dash Disassembly	2
Kit Preparation.....	3
Kit Assembly	4
Axxess Interface Installation	5-8
Final Assembly	9

WIRING & ANTENNA CONNECTIONS (sold separately)

Wiring Harness: Visit metraonline.com for audio/video and steering wheel control interface options.
Antenna Adapter: Included

TOOLS REQUIRED

- Panel removal tool • Phillips screwdriver
- Socket wrench

Attention! With the key out of the ignition, disconnect the negative battery terminal before installing this product. Ensure that all installation connections are secure before cycling the ignition to test this product.

DASH DISASSEMBLY

1. Unclip and remove the a/c vent trim panel. (Figure A)
2. Remove (2) Phillips screws securing the radio/climate control panel then unclip and remove the panel. (Figure B)
3. Remove (4) Phillips screws securing the radio, then unplug and remove the radio. (Figure C)

Continue to Kit Preparation

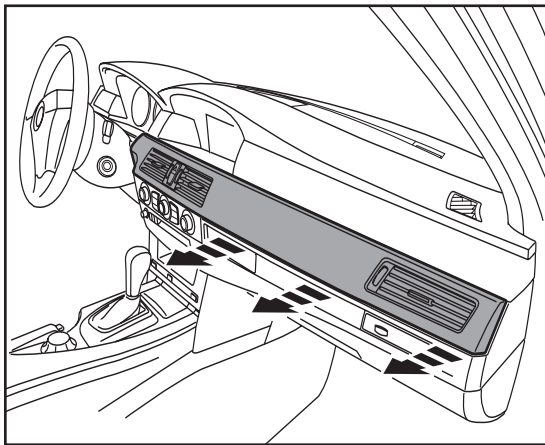

(Figure A)

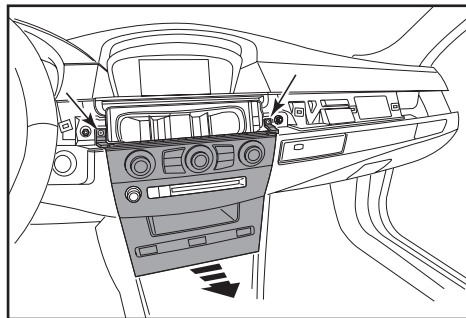

(Figure B)

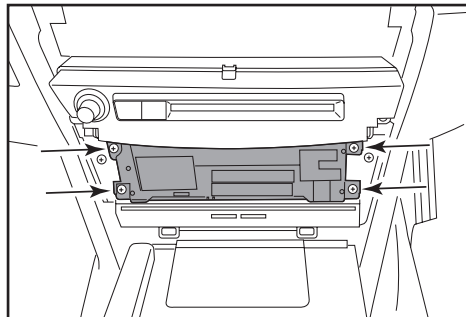

(Figure C)

KIT PREPARATION

1. Unclip climate control from the factory trim panel. (Figure A)
2. Unclip the button panel from the bottom of the factory trim panel. (Figure A)
3. Secure the **climate control panel** to the **radio trim panel** using the (2) #8 x 3/8" Phillips screws provided. (Figure B)

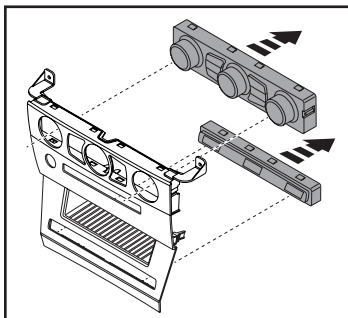

(Figure A)

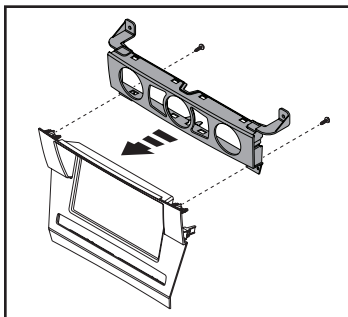

(Figure B)

3. Snap the factory climate control into the **climate control trim panel**. (Figure C)
4. Snap the button panel into the bottom opening of the **radio trim panel**. (Figure C)
5. Attach the (4) supplied **panel clips** to the radio housing. (Figure D)

Continue to Kit Assembly

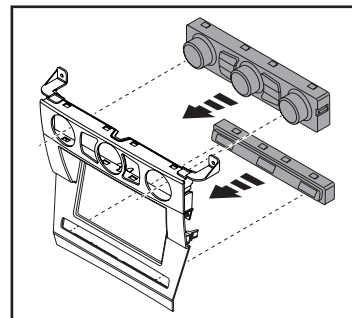

(Figure C)

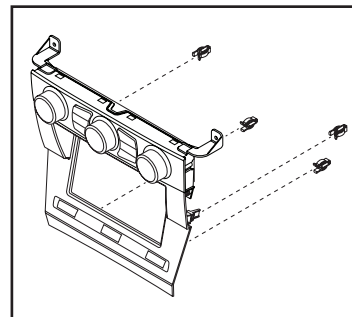

(Figure D)

KIT ASSEMBLY

1. Attach the **radio brackets** to the radio using screws supplied with the radio, and then secure into the dash opening. (Figure A)
2. Find a suitable location for the factory radio chassis. Route the included radio relocation harness and plug the proper ends into the factory radio chassis.

*Continue to Axxess
Interface Installation*

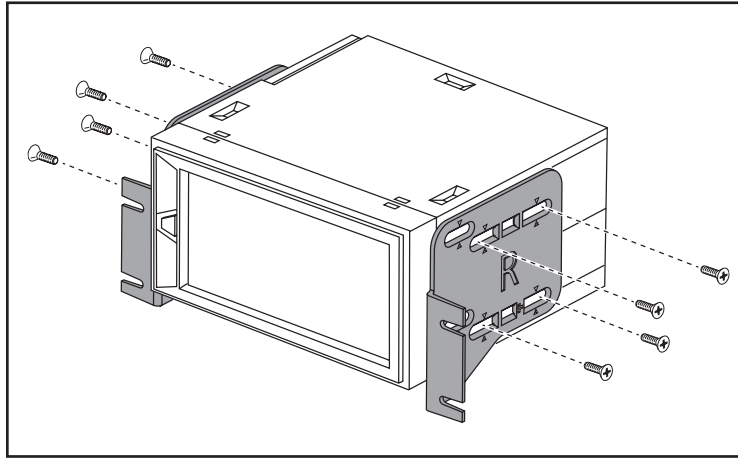

(Figure A)

AXXESS INTERFACE INSTALLATION

INTERFACE COMPONENTS

- 95-9328B interface
- LD-SWCX-BMIT
- LD-LVDS-BMW

INTERFACE FEATURES

- Provides accessory power (10-amp)
- Retains warning chimes through an onboard speaker
- Retains audio controls on the steering wheel
- Retains use of i-Drive
- Designed to be compatible with all major radio brands
- Auto detects vehicle type, radio connection, and preset controls
- Ability to dual assign steering wheel control buttons
- Retains memory settings even after battery disconnection or interface removal (non-volatile memory)
- Designed for non-amplified models, or when bypassing a factory amplifier
- Retains balance and fade
- Micro-B USB updatable

TABLE OF CONTENTS

Connections.....	6
Programming.....	7
Troubleshooting.....	8

TOOLS REQUIRED

- Crimping tool and connectors, or solder gun, solder, and heat shrink • Tape
- Female Spade Connectors (Optional)

Important: Before beginning any of the following, disconnect the negative battery terminal to prevent an accidental short circuit.

The included interface with this kit is designed to retain Onstar®, and retain factory warning chimes, and keep the factory climate display active. It also provides a 12-volt accessory output, mute, park brake, speed signal and reverse output.

CONNECTIONS

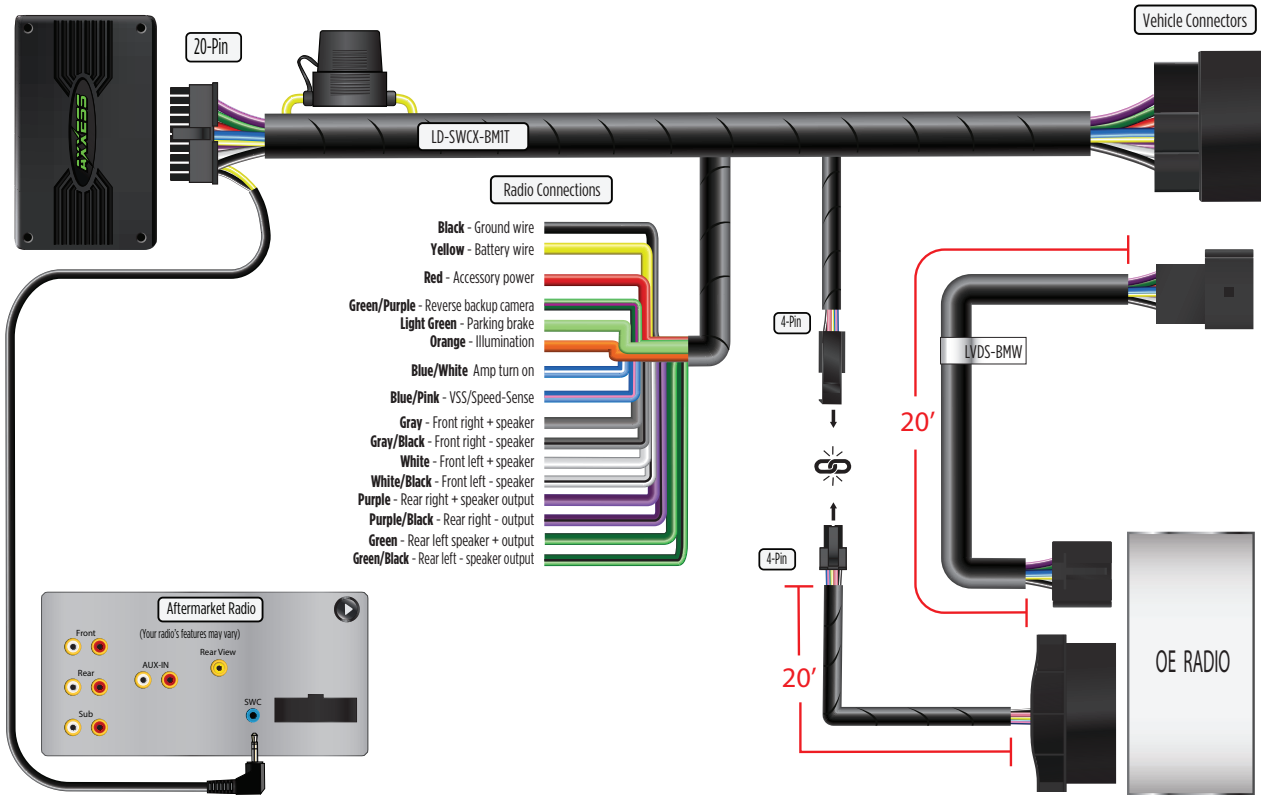

PROGRAMMING

1.  Open the driver's door, and keep open during the programming process.

2.  Cycle the ignition on.

3.  Connect the **AXTC-BM1 harness** to the **AXTC-BM1 interface**, and then to the wiring harness in the vehicle.

- 4.*  Tap **Volume Up** Locate the **Volume Up** button on the the steering wheel. Program the interface by tapping the **Volume Up** button until the LED stops flashing.
*Only applicable if vehicle came with steering wheel controls

- 5.*  The LED will flash **Green & Red** while the interface programs the radio to the steering wheel controls. Once programmed, the LED will go out, then produce a pattern which will identify the radio type installed. Refer to the **Radio LED Feedback** section under **Troubleshooting** for radio types.

*Only applicable if vehicle came with steering wheel controls

6.  The LED will go out, then once again quickly flash **Green & Red** while the interface programs itself to the vehicle. Once programmed, the LED will go out again, then turn solid **Green**.

7.  Cycle the ignition off, then back on.

8.  Test all functions of the installation for proper operation.

TROUBLESHOOTING

1.

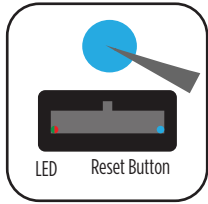

If the interface fails to function, press and release the reset button, then repeat the programming process from step 4 to try again.

2. Final LED Feedback

At the end of programming the LED will turn **Solid Green** which indicates programming was successful. If the LED didn't turn **Solid Green**, reference the list below to understand which programming section the problem may stem from.

LED Light	Radio Programming Section	Vehicle Programming Section
Solid Green	Pass	Pass
Slow Red Flash	Fail	Pass
Slow Green Flash	Pass	Fail
Solid Red	Fail	Fail

Note: If the LED shows **Solid Green** for **Pass** (indicating everything programmed correctly), yet the steering wheel controls don't work, make sure that the 3.5mm jack is plugged in, and plugged into the correct jack in the radio. Once corrected, press the reset button, then program again.



Further troubleshooting steps and information can be located at:

axxessinterfaces.com/product/95-9328B

Continue to Final Assembly

FINAL ASSEMBLY

1. Be sure to reconnect the lower button panel and then snap the **radio trim panel** over the radio and reassemble the dash in reverse order of disassembly.







95-9328B
INSTALLATION INSTRUCTIONS



Having difficulties? We're here to help.



Contact our Tech Support line at:

386-257-1187



Or via email at:

techsupport@metra-autosound.com

Tech Support Hours (Eastern Standard Time)

Monday - Friday: 9:00 AM - 7:00 PM

Saturday: 10:00 AM - 5:00 PM

Sunday: 10:00 AM - 4:00 PM



**Metra recommends MECP
certified technicians**