



Fits Toyota

Sequoia 2003-2007, Tundra 2003-2006

Visit MetraOnline.com for more detailed information about the product and up-to-date vehicle specific applications

KIT FEATURES

- Stereo installation kit designed to fit any standard 2" tall aftermarket radio utilizing our patented quick-release, snap-in ISO mount system with custom trim ring
- Made from the highest quality ABS plastic for an original factory-like fit and finish

KIT COMPONENTS

- A) Radio housing with pocket • B) ISO snap-in brackets • C) ISO trim plate • D) DIN spacer

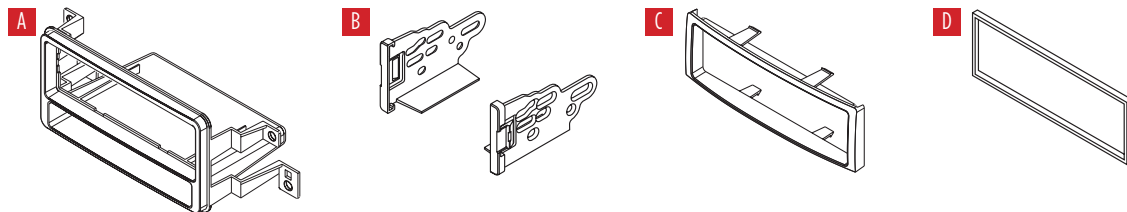

TABLE OF CONTENTS

Dash Disassembly	2
Kit Assembly:	
DIN head unit with pocket	3
ISO DIN head unit with pocket	3

WIRING & ANTENNA CONNECTIONS

(sold separately)

Visit axessinterface.com for A/V and SWC or audio, video, and steering wheel control interface options.

Wiring Harness: 70-1761 (non amplified)

70-8113 (2003-2004 amplified)

Antenna Adapter: Not required

TOOLS REQUIRED

- Phillips screwdriver • Socket wrench

Attention! With the key out of the ignition, disconnect the negative battery terminal before installing this product. Ensure that all installation connections are secure before cycling the ignition to test this product.

DASH DISASSEMBLY

Toyota Sequoia 2003-2007

1. Position vents facing upward and remove (1) Phillips screw from each A/C vent. (Figure A)
2. Unclip and remove entire radio trim panel including climate controls. (Figure B)
3. Remove (4) 10mm bolts to remove radio. (Figure C)

Continue to Kit Assembly

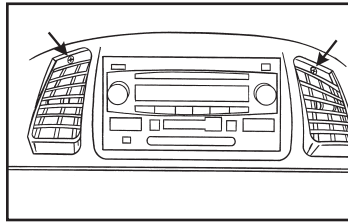

(Figure A)

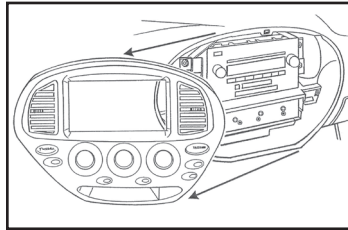

(Figure B)

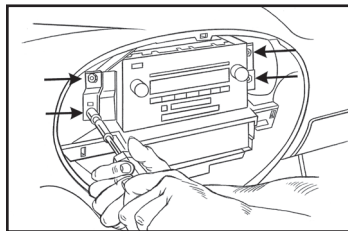

(Figure C)

Toyota Tundra 2003-2006

1. Remove the (3) climate control knobs by pulling straight outward. (Figure A)
2. Remove (3) Phillips screws from behind knobs. (Figure A)
3. Position vents facing upward and remove (1) Phillips screw from each A/C vent. (Figure B)
4. Unclip and remove entire radio trim panel including climate controls. (Figure C)
5. Remove (4) 10mm bolts to remove radio. (Figure D)

Continue to Kit Assembly

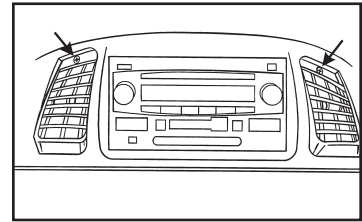

(Figure B)

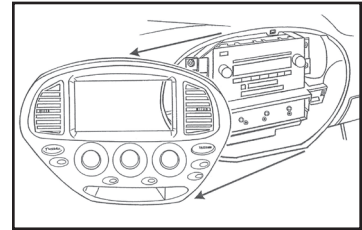

(Figure C)

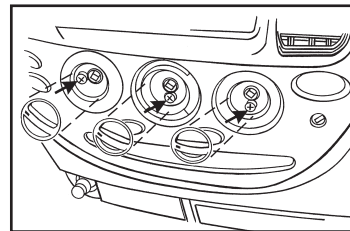

(Figure A)

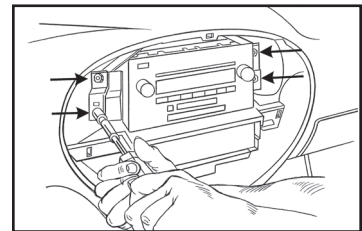

(Figure D)

KIT ASSEMBLY

DIN head unit provision with pocket

1. Slide DIN cage (supplied with radio) into the **radio housing** from the front. (Figure A)
2. Secure DIN cage to **radio housing** by bending the locking tabs outward. (Figure A)
3. Slide the radio into the DIN cage until it snaps into place. (Figure B)

Note: A DIN spacer has been provided if extra depth is required. This will go into the radio housing before the sleeve. (Figure C)

4. Locate the factory wiring harness and antenna connector in the dash, and complete all necessary connections to the radio. Metra recommends using the proper mating adapter from Metra and/or AXXESS. Re-connect the negative battery terminal and test the radio for proper operation.
5. Secure the radio assembly into the dash opening.
6. Reassemble the dash in reverse order of disassembly.

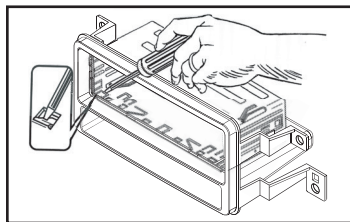

(Figure A)

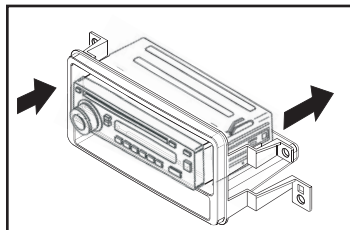

(Figure B)

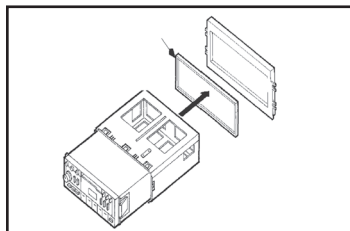

(Figure C)

ISO DIN head unit provision with pocket

1. Align the holes in the **ISO brackets** with the holes in the radio. Mount the brackets to the radio using screws supplied with the radio. (Figure A)
2. Slide the radio bracket assembly into the **radio housing** until it snaps into place. (Figure B)
3. Snap the **ISO trim-plate** onto the front of the assembled radio and housing. (Figure B)

Note: To remove the radio unsnap and remove the ISO trim-plate. Using a flat blade screwdriver disengage ISO brackets from the radio housing and slide radio out of radio housing.

4. Locate the factory wiring harness and antenna connector in the dash, and complete all necessary connections to the radio. Metra recommends using the proper mating adapter from Metra and/or AXXESS. Re-connect the negative battery terminal and test the radio for proper operation.
5. Secure the radio assembly into the dash opening.
6. Reassemble the dash in reverse order of disassembly.

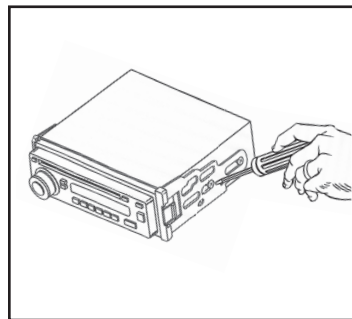

(Figure A)

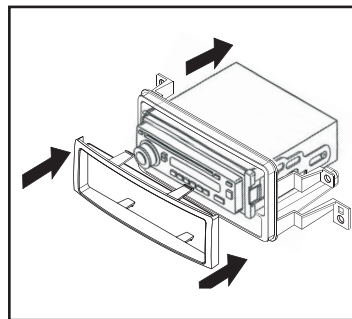

(Figure B)



99-8207
INSTALLATION INSTRUCTIONS



Having difficulties? We're here to help.



Contact our Tech Support line at:

386-257-1187



Or via email at:

techsupport@metra-autosound.com

Tech Support Hours (Eastern Standard Time)

Monday - Friday: 9:00 AM - 7:00 PM

Saturday: 10:00 AM - 5:00 PM

Sunday: 10:00 AM - 4:00 PM



**Metra recommends MECP
certified technicians**